

Project the missing views exercise 1

In first angle orthographic projection, draw the missing:

- a) **Front view** from the direction of the arrow shown,
- b) **First Angle** symbol

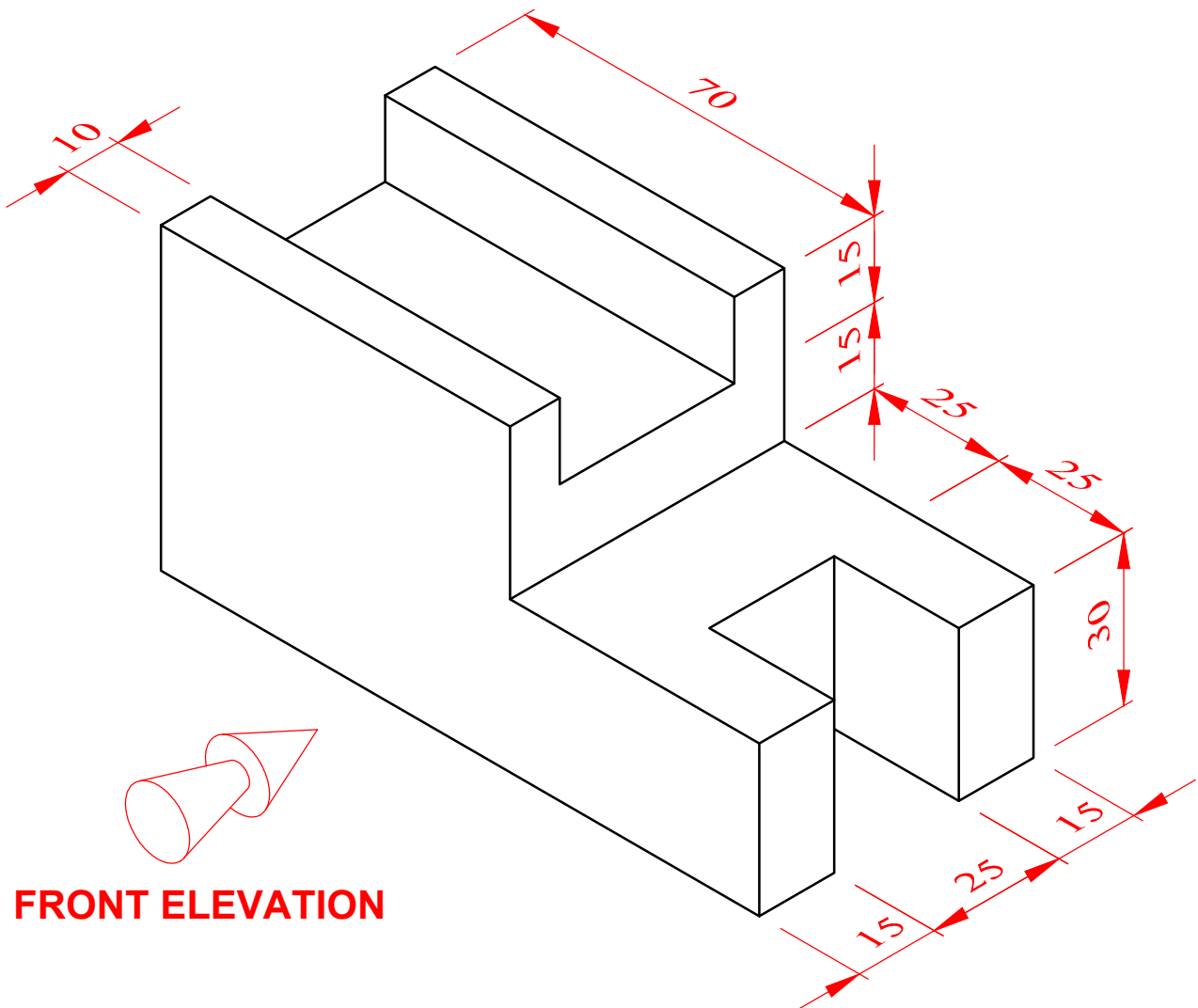

If you have difficulty placing the views and spacing them neatly, you can use the starter sheet provided to help you. As you improve, try completing the drawing without the use of the starter sheet.

To help you visualize the object better you can visit:

<https://youtu.be/ESrSkmT0Ow4> for a video of the object rotating in space.

Project the missing views excercise 1 - STARTER SHEET

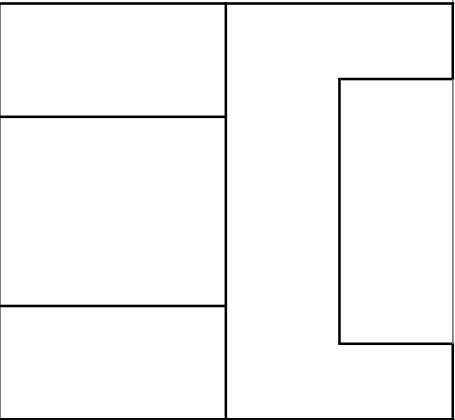

END VIEW

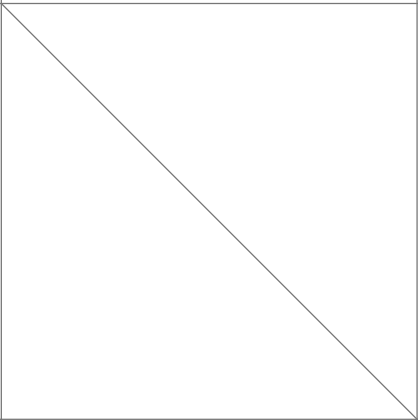

FRONT VIEW

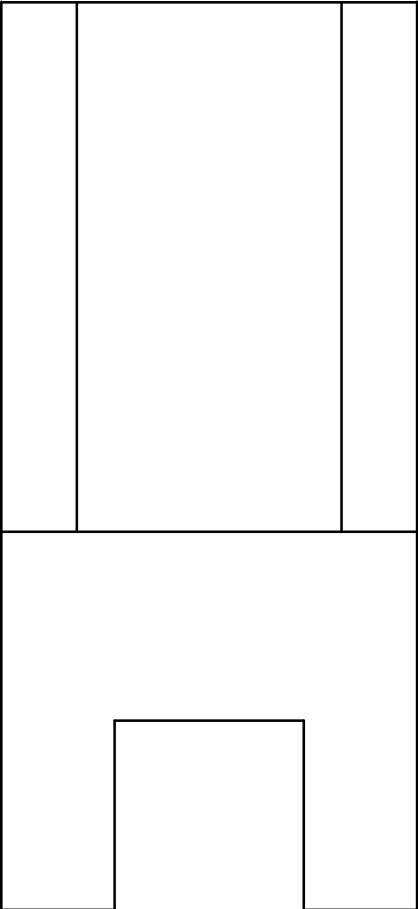

PLAN

Project the missing views excercise 1 - ANSWER

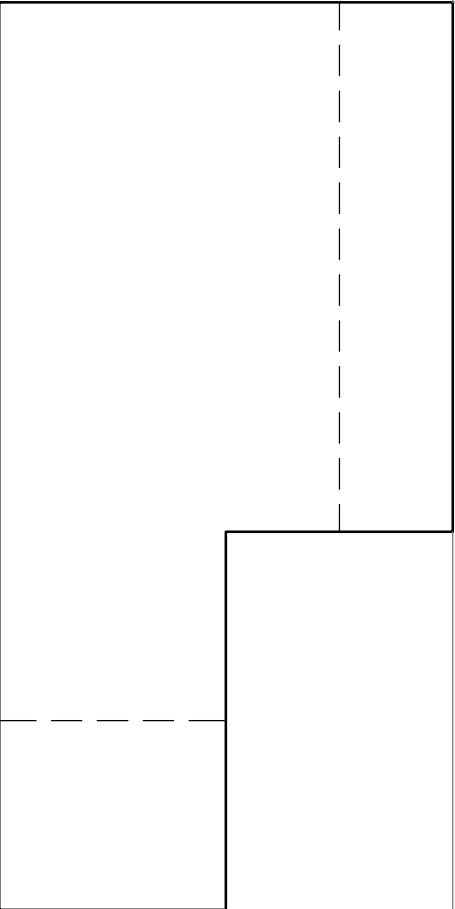
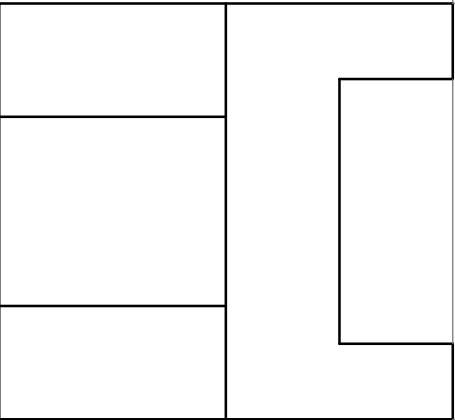

END VIEW

FRONT VIEW

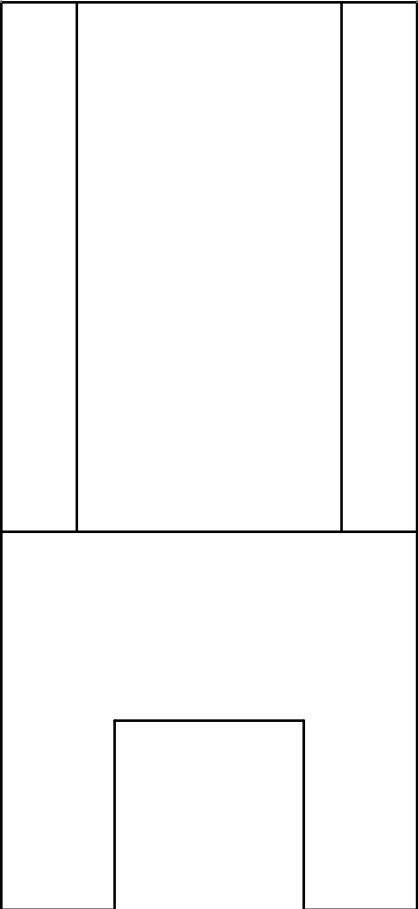
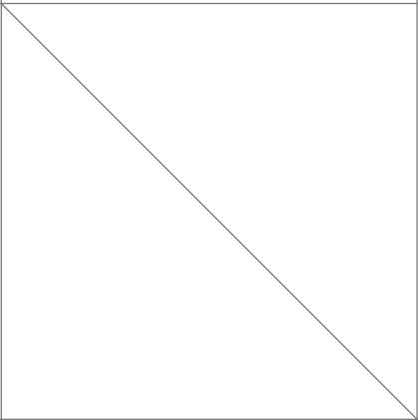

PLAN

