

Orthographic Projection Exercise 2

In first angle orthographic projection, draw the:

- a) **Front view** from the direction of the arrow shown,
- b) **End view** and
- c) **Plan**

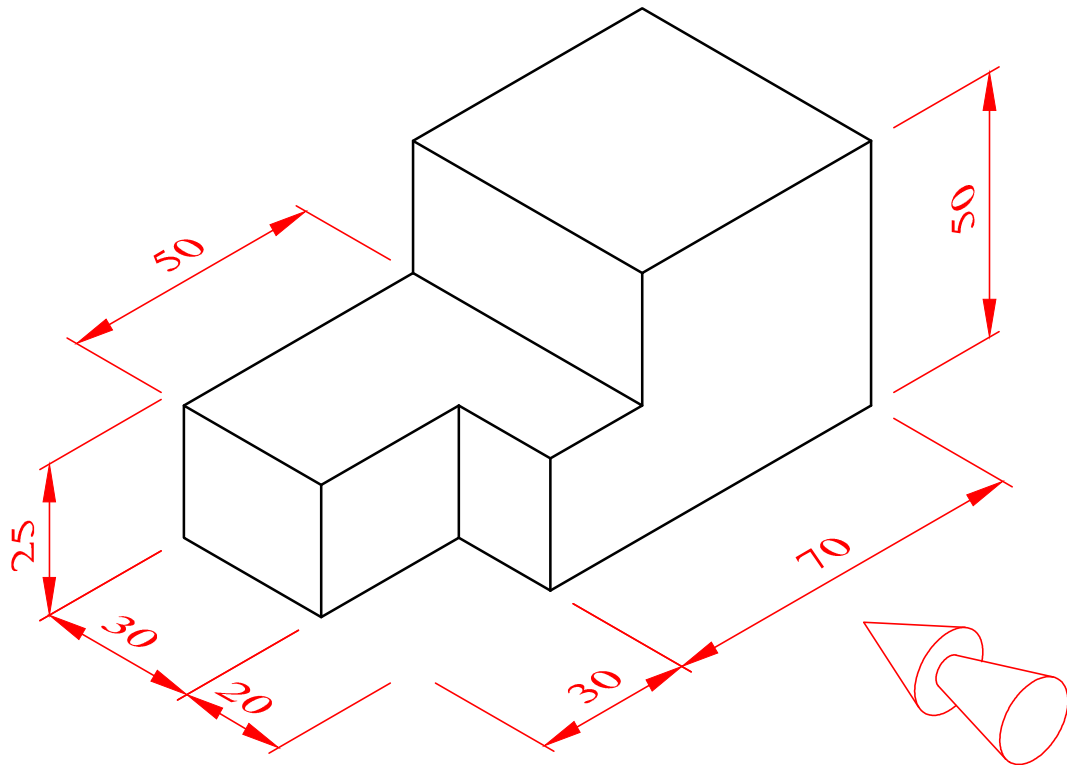

FRONT ELEVATION

If you have difficulty placing the views and spacing them neatly, you can use the starter sheet provided to help you. As you improve, try completing the drawing without the use of the starter sheet.

To help you visualize the object better you can visit:

<https://www.youtube.com/watch?v=CV95hWID9LM> for a video of the object rotating in space or:

<https://www.youtube.com/watch?v=M6KUDfe0KMk> for the same video but with the surface of the object colour coded. The parts of the surface that are seen from the **plan view** are colour coded red, the parts that are seen from the **front view** are colour coded green, and the parts that are seen from the **end view** are colour coded blue.

Orthographic Projection Exercise 2 - STARTER SHEET

FRONT VIEW

END VIEW

PLAN

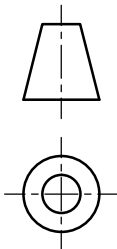

Orthographic Projection Exercise 2 - ANSWER

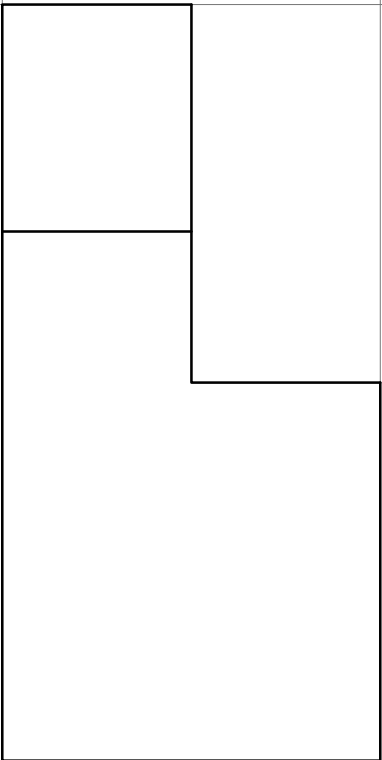

FRONT VIEW

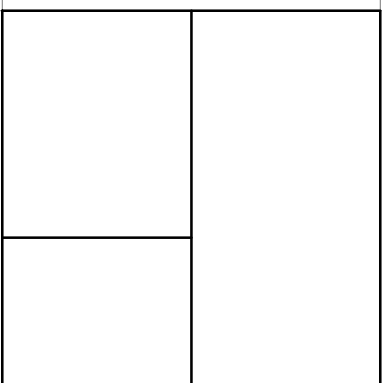

END VIEW

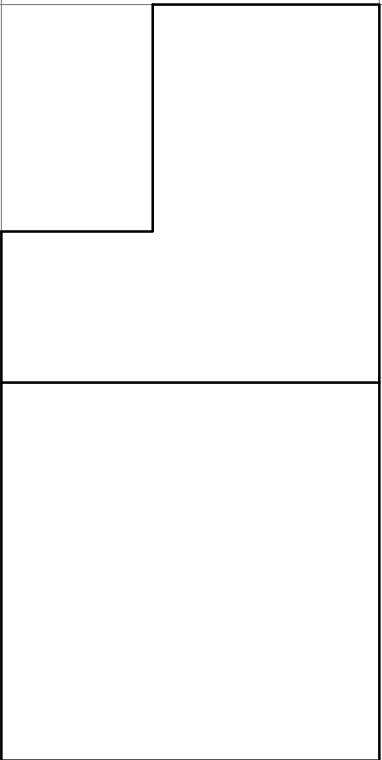

PLAN

