

Advanced triangle constructions.

These are the three advanced triangle constructions in Graphical Communication.

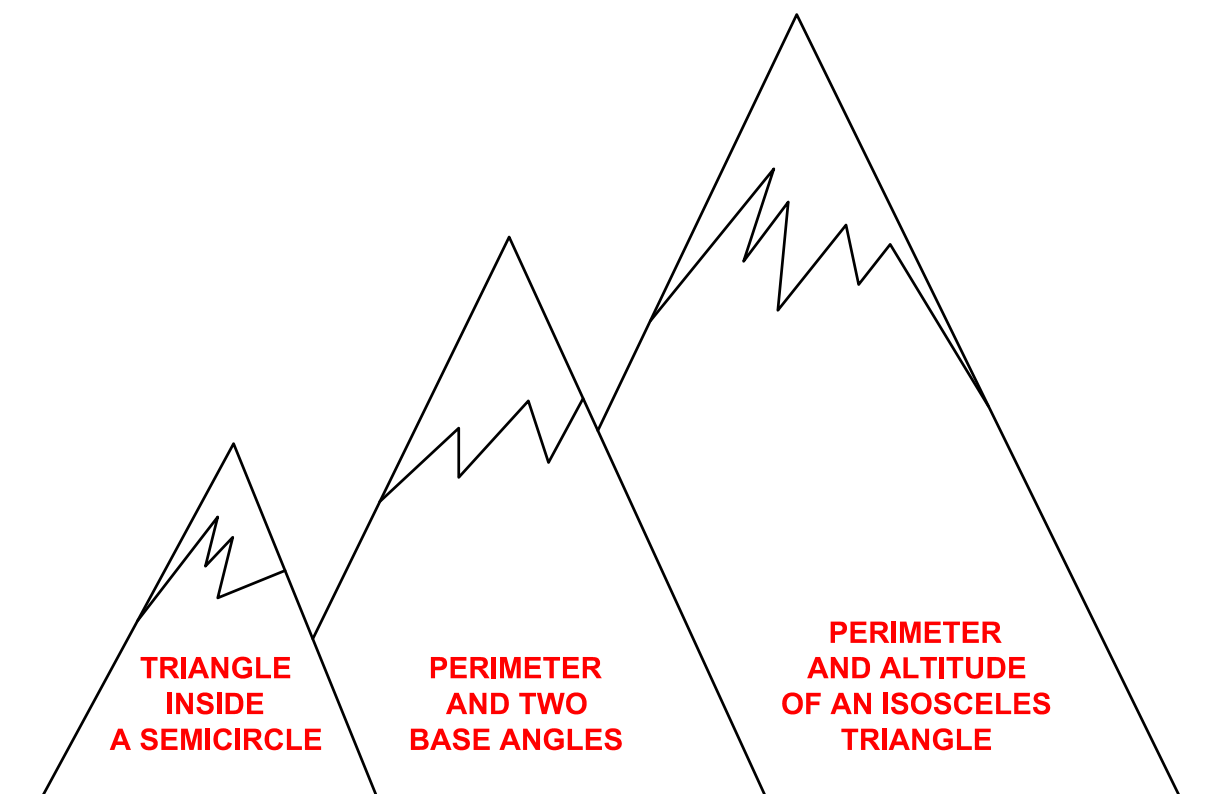

Advanced triangle constructions

You can visit: <https://youtu.be/jemk0ITGA1Q> for a step by step video of the construction method.

Construction of triangles - STARTER SHEET

1) Length of one side / angle and hypotenuse of a right angle triangle

AC = 80
AB = 40
Angle ABC = 90°

AC = 80
Angle BAC = 60°
Angle ABC = 90°

2) Perimeter and two base angles

Perimeter = 105
Angle CAB = 60°
Angle CBA = 40°

3) Perimeter and altitude of an isosceles triangle

Perimeter = 120
VH = 40

Construction of triangles - ANSWER SHEET

1) Length of one side / angle and hypotenuse of a right angle triangle

AC = 80
 AB = 40
 Angle ABC = 90°

AC = 80
 Angle BAC = 60°
 Angle ABC = 90°

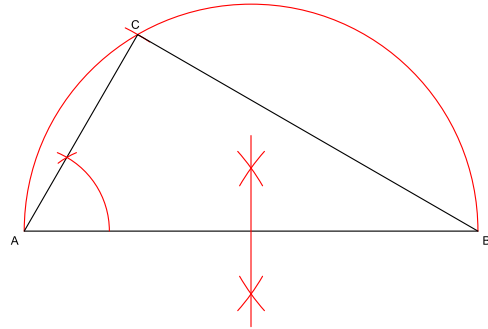
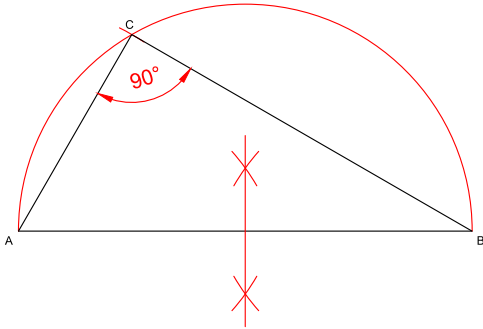

2) Perimeter and two base angles

Perimeter = 105
 Angle CAB = 60°
 Angle CBA = 40°

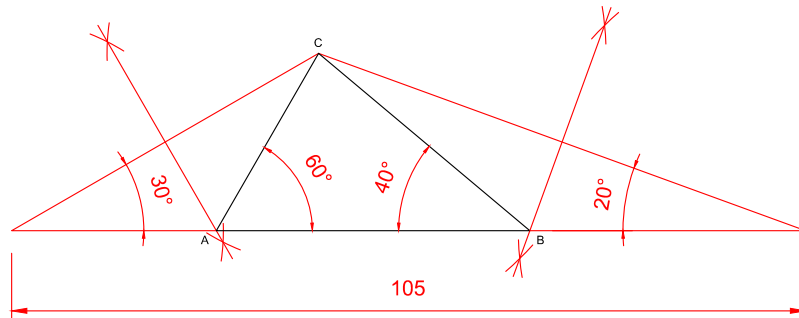

3) Perimeter and altitude of an isosceles triangle

Perimeter = 120
 VH = 40

